

# UNI-SPRAY SYSTEMS INC.

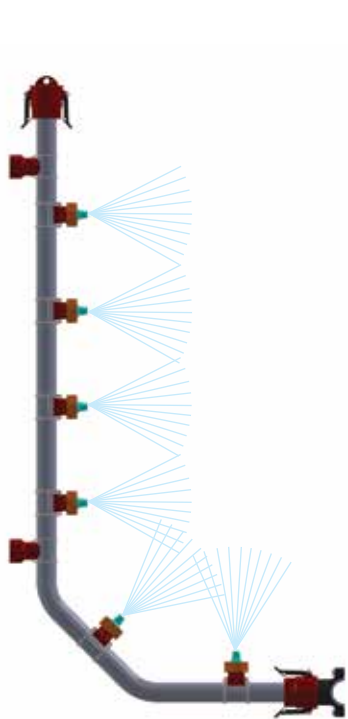

## RISER WORKSHEET

### GENERAL INFO

STAGE NO: \_\_\_\_\_

TANK SIZE (LxWxH): \_\_\_\_\_

TANK CAPACITY; USG : L : \_\_\_\_\_

PUMP CAPACITY: \_\_\_\_\_

OPERATING PRESSURE: \_\_\_\_\_

HEADER SIZE: \_\_\_\_\_

TOTAL NO. OF RISERS PER STAGE: \_\_\_\_\_

### RISER INFO

RISER PIPE SIZE: \_\_\_\_\_

NOZZLE ASS'Y PART NO: \_\_\_\_\_

TOTAL NO. OF NOZ'S PER RISER: \_\_\_\_\_

NO. OF RISER SUPPORTS PER RISER: \_\_\_\_\_

TOTAL NO. OF RISERS OF THIS TYPE FOR THIS ORDER INCLUDING SPARES: \_\_\_\_\_

DATE (M,D,Y): \_\_\_\_\_

NOTES: \_\_\_\_\_

\_\_\_\_\_  
 \_\_\_\_\_  
 \_\_\_\_\_

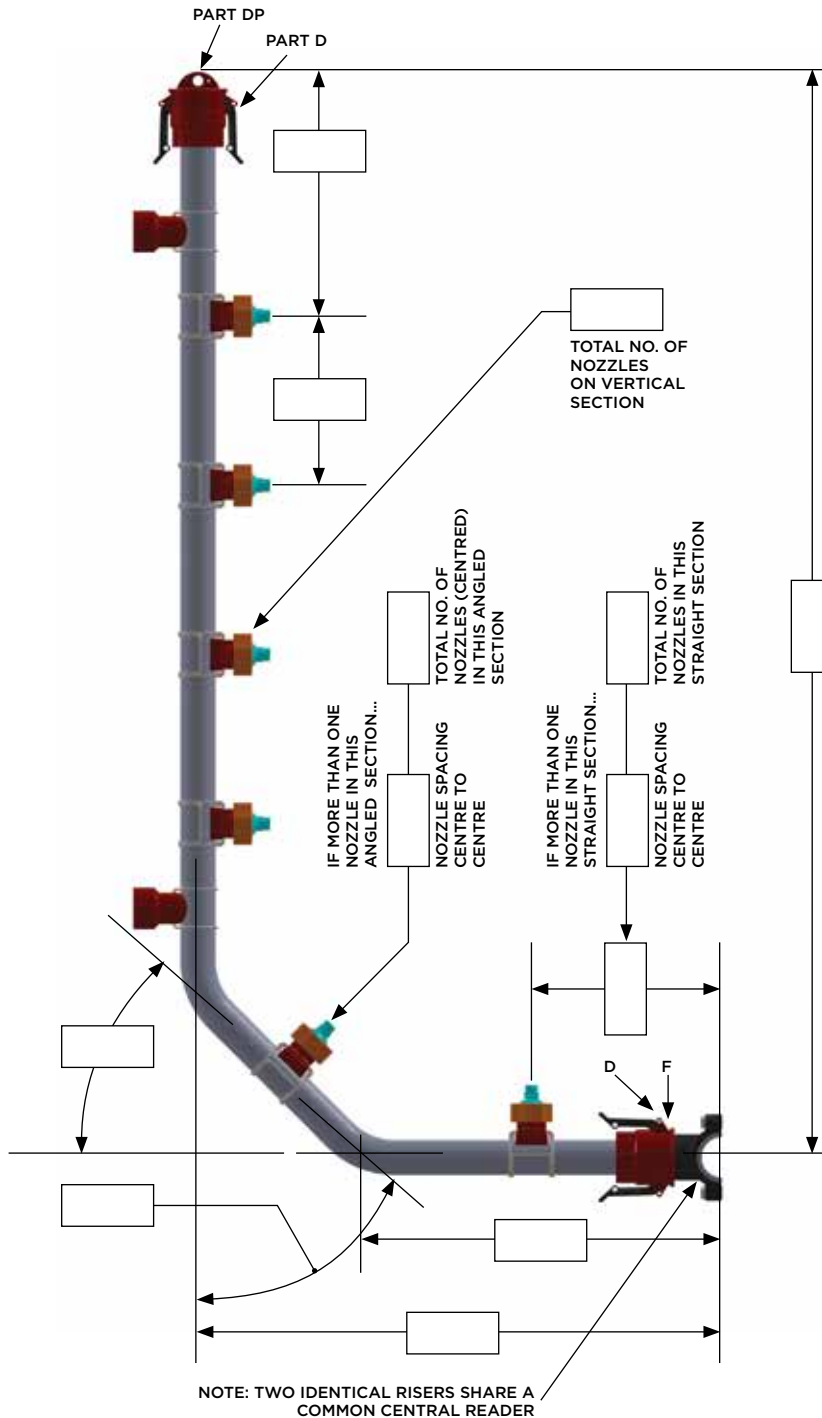

NOTE: TWO IDENTICAL RISERS SHARE A COMMON CENTRAL READER

# R10B

CUSTOMER: \_\_\_\_\_

ADDRESS: \_\_\_\_\_

CONTACT: \_\_\_\_\_

PHONE: \_\_\_\_\_

FAX: \_\_\_\_\_



© Uni-Spray Systems Inc.

CORPORATE OFFICE:  
 44 Durward Place,  
 Waterloo, Ontario,  
 Canada N2L 4E4  
 Tel: (519) 885-4270  
 Fax: (519) 885-4325